

LSL Series

Self-Regulating Heating Cable

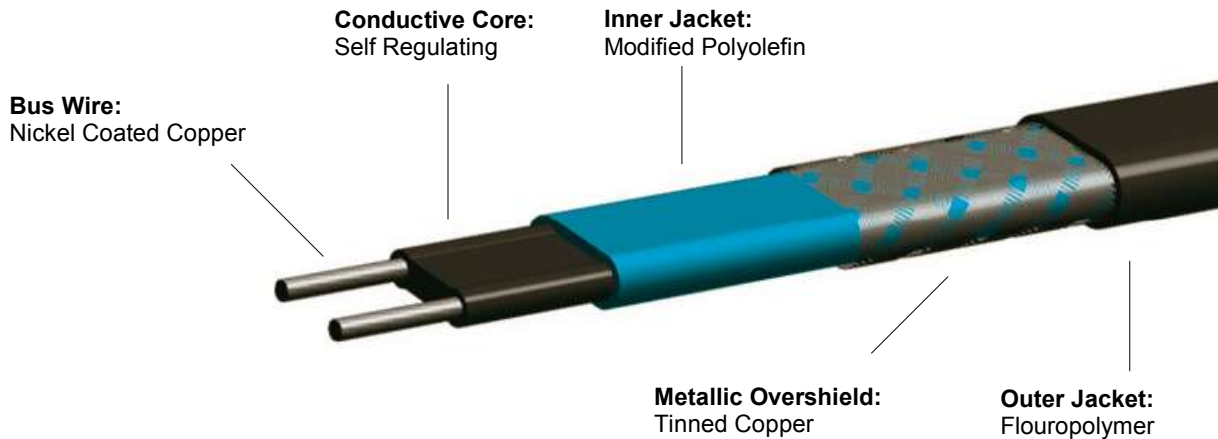

Application

The industrial grade LSL cables provide process temperature maintenance for fluid transport and storage systems. The cables can maintain temperatures up to 65°C (150°F) and will withstand intermittent temperature excursions to 85°C (185°F).

LSL series cables can be cut to length and terminated in the field, and will not overheat or burnout when overlapped.

Technical data

Output wattage:
10, 16, 26, 33 W/m at 10°C
3, 5, 8, 10 W/ft at 50°F

Supply voltage:
240 V (other options are available on request)

Continuous maintenance temperature:
65°C (150°F) max

Intermittent exposure temperature:
85°C (185°F) max

T rating:
T5.. 10, 16, 26 W/m
T6.. 33 W/m

Dimension:
12x8 mm

Min. bending radius:
v/ 20° C 15 mm
v/-40° C 25 mm

Approvals:
ATEX, Factory Mutual, CSA, UL, Semco

Products

Art. no.	Description	W/m
2703-21T00	Self-regulating heating cable LSL	10
2705-21T00	Self-regulating heating cable LSL	16
2708-21T00	Self-regulating heating cable LSL	26
2710-21T00	Self-regulating heating cable LSL	33

LSL Series

Self-Regulating Heating Cable



Maximum cable length (meter)

Temperature	Type	16 A	20 A	25 A	32 A	40 A
+10°C	LSL10	201	-	-	-	-
	LSL16	150	165	-	-	-
	LSL26	96	119	123	128	-
	LSL33	75	93	101	110	-
-30°C	LSL10	117	146	174	201	-
	LSL16	85	105	132	165	-
	LSL26	55	69	86	111	128
	LSL33	42	53	66	85	110

Accessories

Art. no.	Description
615 022 016	Connection and end termination set
010 062 612	Cold leads, silicon insulated 3x1,5 mm ²
010 063 612	Cold leads, silicon insulated 3x2,5 mm ²
010 064 612	Cold leads, silicon insulated 3x4,0 mm ²
160 90	Thermostat controller, -15°C ... + 95°C, see next page for details
161 50	Thermostat controller, -15°C ... + 150°C, see next page for details

Visit Us at: www.hemiheating.com

LSL Series

Self-Regulating Heating Cable

HEMI HEATING
SURFACE HEATING SYSTEMS

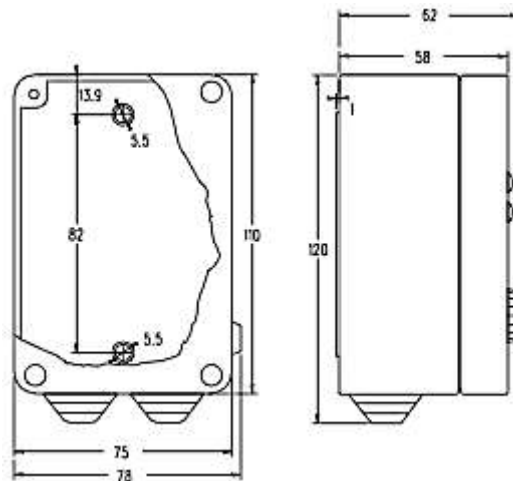

Description

The 16000 series electronic thermostats are ideal for use together with heating cables. They come with a sensor and have a wide temperature range from -15°C to $+150^{\circ}\text{C}$.

The units are supplied with LED indicators for sensor fault and power output status (on/off).

Technical data

Supply voltage:
230 V

Max breaking current:
10A / 250V

Ambient temperature:
 -10°C ... $+55^{\circ}\text{C}$

Temperature difference:
adjustable 1-10K

Electrical life expectancy:
 1×10^5

Mechanical life expectancy:
 1×10^6